



SafeSeal closures
L (green), M (red), S (blue)

The SafeSeal opener
in the sizes L, M, S.
For the easy opening of
the different SafeSeal
closures.

SafeSeal Opener – Handling

The Lugaia SafeSeal system ensures safe and universal sealing of films (e.g. continuous liner).

The **SafeSeal opener** extends the handling with this system by another function.

A sealed film package can be reopened without additional cutting or the use of pointed tools. The SafeSeal closure is then pushed apart with the SafeSeal opener and separated from each other in the shortest possible time.



Opening the closures sizes S and M



Lugaia SafeSeal closure

Insert the opener, the outer crimp opens

Separate crimps from each other

Opening the closure size L

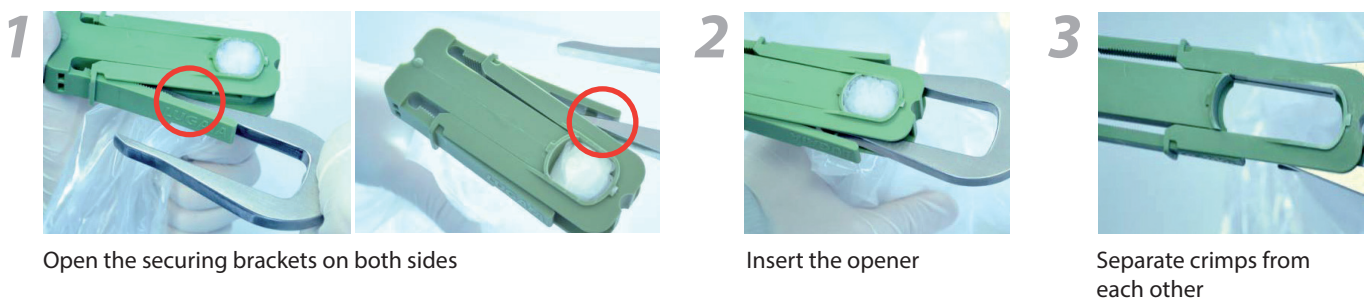

Open the securing brackets on both sides

Insert the opener

Separate crimps from each other

Contact:
info@biopharmequip.com
562 355-5859